

505 E. SHIAWASSEE STREET



**AVAILABLE SPACE
FOR LEASE**
Approx. 2,000 SF

Renderings are for inspirational and discussion purposes only



FUTURE DEVELOPMENTS
EXISTING DEVELOPMENTS

PROPERTY INFO

- Approx. 2,000 Square Feet of available space
- Interior can be designed to accommodate tenant needs
- Three new residential lofts on second floor
- Prominent building signage available
- Highly visible corner building
- One block north of the game changer BLOCK600
 - Capital City Market by Meijer
 - Courtyard by Marriott hotel
- Surrounded by 15+ bars and restaurants
- Footsteps away from Jackson Field, Lansing River Trail and Lansing Center
- Close proximity to the Michigan State Capitol: 0.5 miles

DETAILS

- Rental Rate: \$17.50/SF NNN
- NNN Est.: \$6.00/SF
- Delivery: White Box Condition

CONTACT

MEGAN WEBER

Leasing and Business Development
Manager
517.333.4123
mweber@gillespie-group.com

VERONICA AZAR

Leasing and Business Development
Coordinator
517.333.4123
vazar@gillespie-group.com

**JOIN THE GROWTH AND ENERGY OF
THE THRIVING STADIUM DISTRICT TODAY!**

GILLESPIE-GROUP.COM



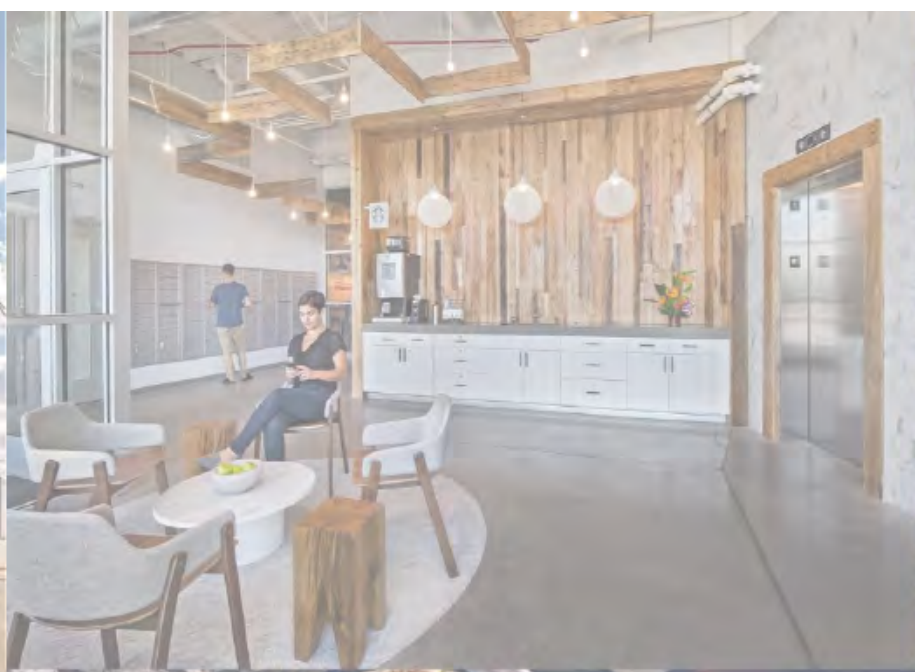

**JOIN THE ENERGY
OF LANSING'S FASTEST
GROWING DISTRICT TODAY!**

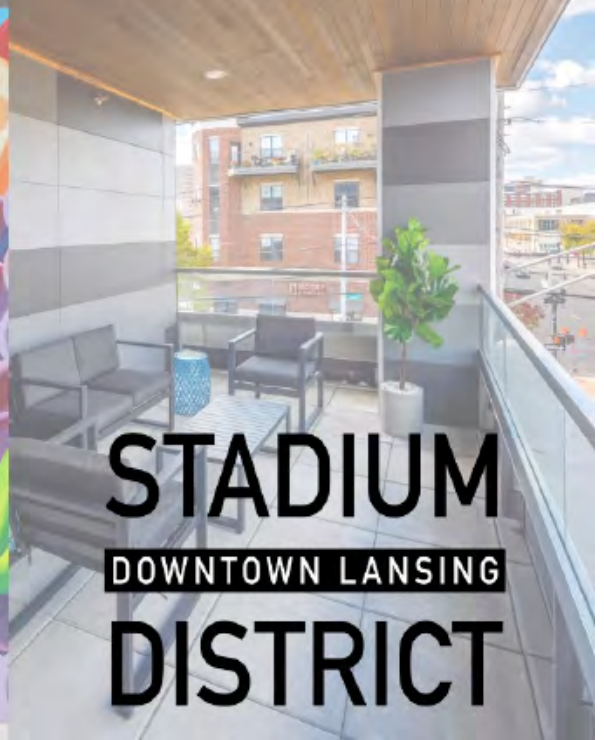

**STADIUM
DOWNTOWN LANSING
DISTRICT**

FLOOR PLAN EXAMPLE:

